

MegaVAL® fuses are compliant with ISO 8820-5 Standard, recommended for the protection of heavy cross-section wires with heavy current duty. MegaVAL® are made of Zinc alloy (100 ÷ 250 A) and Copper (300A÷500A), to optimize the performance to the nominal current.

Breaking capacity: 2000[A]
Voltage rating: 32[Vdc]
Ambient Temperature: -40°C to +125°C

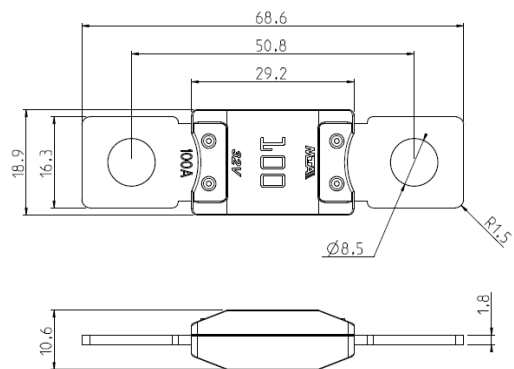

MTA/ISO MegaVAL® operating time limits		
% In	min [s]	max [s]
1,00	14400 (a)	-
1,35	120 (a)	1800 (a)
2,00	1	15
3,50	0,3 (b)	5
6,00	0,1 (a)	1 (a)



(a) Not applicable for 300A÷500 A. (b) 0,5 for 300A÷500A

MegaVAL® Operating Time
 @23°C test module ISO

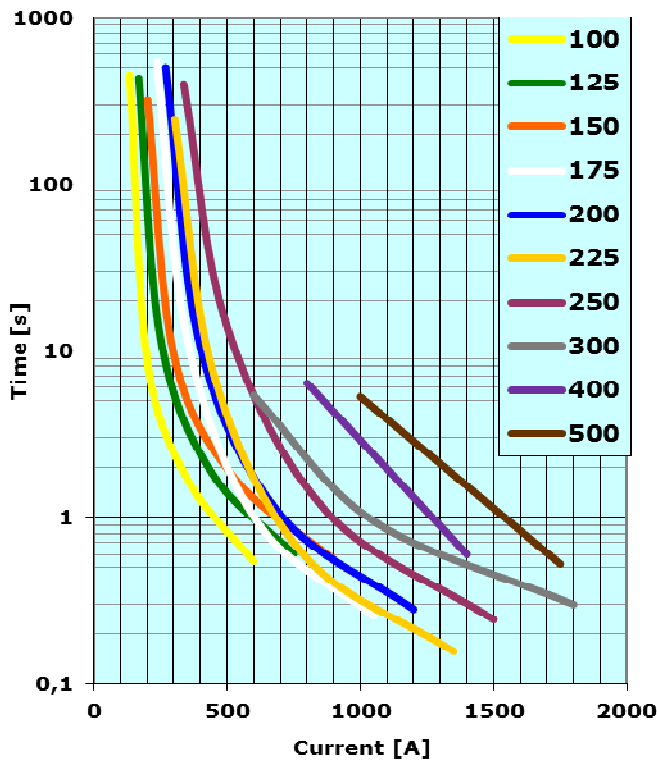

MegaVAL® Re-Rating Curve.
 Test module ISO

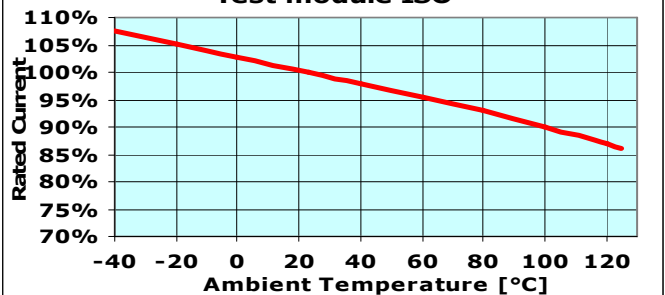

CURRENT RATING [A]	VOLTAGE DROP @ current rating [mV]	CABLE SIZE [mm ²]	I ² t* [A ² s]
100	86	16	219583
125	85		353125
150	93	25	463167
175	80		303521
200	81	35	416250
225	100		296042
250	80	50	637500
300	75,2		880000
400	75,0	70	1028000
500	80		1892000

*calculated from breaking capacity test