

ISO 9001:2008 by L.R.  
PED DIR. 97/23/EC by L.R.  
ATEX DIR. 94/9/EC by B.V.  
FIRE SAFE EXECUTION by L.R.  
ISO 15848 by TÜV  
ANTISTATIC DEVICE by L.R.  
FIRE SAFE TESTED ISO 10497 by L.R.

TYPE  
**FV4**  
PN 10 ÷ 40  
ANSI 150

NORME E DIRETTIVE APPLICATE DISPONIBILI AL SEGUENTE LINK:  
STANDARD AND DIRECTIVE APPLIED AVAILABLE AT FOLLOWING LINK:  
[http://www.adlerspa.com/pdf/NORME\\_ADLER.pdf](http://www.adlerspa.com/pdf/NORME_ADLER.pdf)

## VALVOLE A SFERA "3 VIE CORPO PIATTO" PASSAGGIO TOTALE 120°

ISO nbr° LRC 0160281 QMS issued by L.R.Q.A. PED nbr° COV 0212112/01 issued by L.R.V.  
ATEX nbr° 40.2003.4392 issued by B.V. ISO 15848 nbr° I-148466/1-/2 issued by TÜV

On request  
S.I.L. 3  
According to IEC 61508

VALVE WITH  
PNEUMATIC  
ACTUATORS,  
LIMIT SWITCHES  
AND GEAR BOX

CONSTRUCTION  
ACCORDING TO:  
ANSI B16.34 -  
BS EN 12516-2

FULL BORE ACCORDING  
TO ISO 14313

On request  
FIRE SAFE  
According to ISO 10497  
"ISO-FT"

**BALL VALVES "3 WAY WAFER" FULL BORE 120°**  
**ROBINETS A BOISSEAU SPHERIQUE**  
**"3 VOIES WAFER" PASSAGE INTEGRAL 120°**  
**KUGELHÄHNE "3 WEGE KOMPAKTHAHN"**  
**VOLLER DURCHGANG 120°**

WEB SITE: [WWW.ADLERSPA.COM](http://WWW.ADLERSPA.COM)

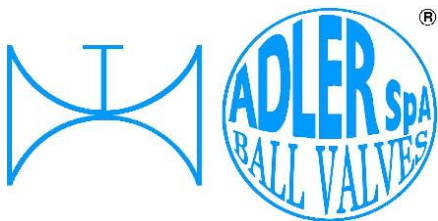

ISO 9001:2008 by L.R.  
 PED DIR. 97/23/EC by L.R.  
 ATEX DIR. 94/9/EC by B.V.  
 FIRE SAFE EXECUTION by L.R.  
 ISO 15848 by TÜV  
 ANTISTATIC DEVICE by L.R.  
 FIRE SAFE TESTED ISO 10497 by L.R.

TYPE  
**FV4**  
 PN 10 ÷ 40  
 ANSI 150

**VALVOLA A SFERA "3 VIE" PASSAGGIO TOTALE 90°**  
**BALL VALVES "3 WAY" FULL BORE 90°**  
**ROBINETS A BOISSEAU SPHERIQUE "3 VOIES" PASSAGE INTEGRAL 90°**  
**KUGELHÄHNE "3 WEGE" VOLLER DURCHGANG 90°**

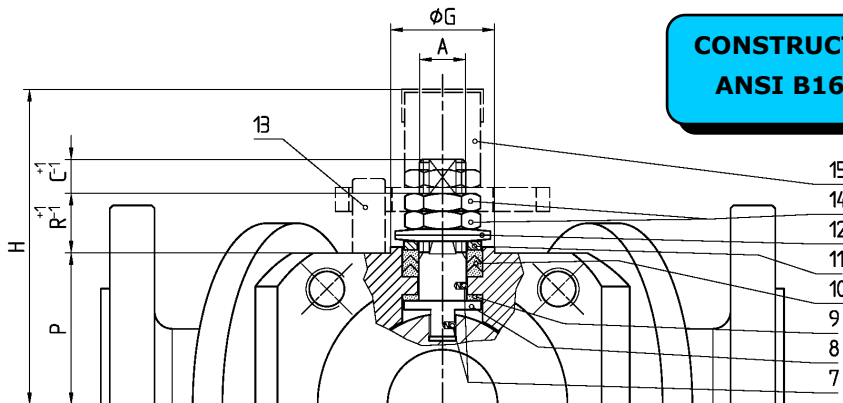

**CONSTRUCTION ACCORDING TO:**  
**ANSI B16.34 - BS EN 12516-2**

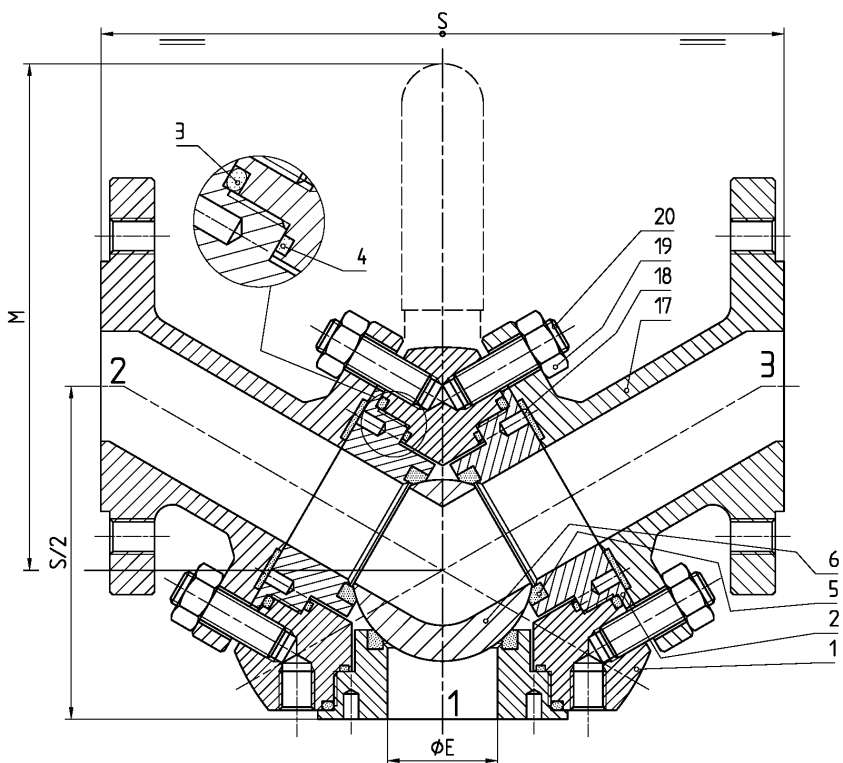

DN 150 ÷ 200  
 -CONSIGLIATO  
 RIDUTTORE MANUALE  
 -MANUAL GEAR BOX  
 SUGGESTED  
 -REDUCTEUR MANUEL  
 CONSEILLE  
 -EMPFEHLEN WIR EIN  
 HANDGETRIEBE

POSIZIONI OTTENIBILI  
 OBTAINABLE POSITIONS  
 POSITIONS OBTENABLES  
 MÖGLICHE STELLUNGEN

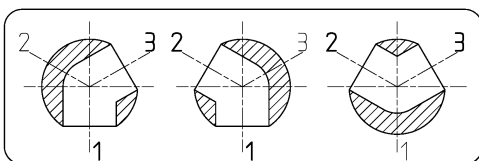

- ACCOPPIAMENTO VALVOLA ATTUATORE
- CONNECTION VALVE ACTUATOR
- ACCOUPLEMENT ROBINET-ACTIONNEUR
- ZUSAMMENBAU KUGELHAHN ANTRIEB

**ISO-5211**

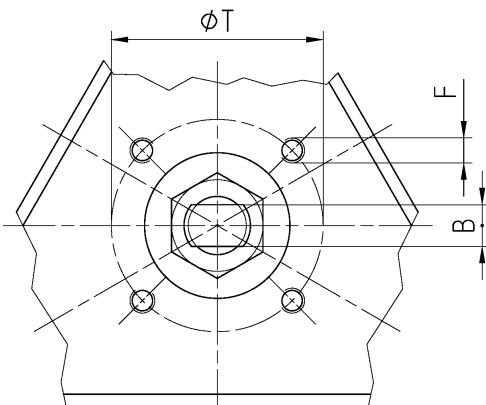

N.	DESCRIZIONE DESCRIPTION BESCHREIBUNG	MATERIALI MATERIALS MATERIAUX WERKSTOFFE
1	CORPO BODY CORPS KÖRPER	ASTM A105 ASTM A479 316/316L ASTM A351 CF8M
2	GHIERA INSERT EMBOUT GEWINDEDRUCKRING	ASTM A105 ASTM A479 316/316L ASTM A351 CF8M
3*	O-RING	FKM - (VITON)
4*	ANELLO SEAL ANNEAU DICHTUNGSRING	P.T.F.E.
5*	SEDE SEAT SIEGE SITZRING	P.T.F.E. (BAM CERTIFIED) R.P.T.F.E. (OPTIONAL)
6	SFERA BALL BOULE KUGEL	ASTM A479 304/304L ASTM A351 CF8 ASTM A479 316/316L ASTM A351 CF8M
7	DISPOSITIVO ANTISTATICO ANTISTATIC DEVICE CONTACT ANTISTATIQUE ANTISTATIK VORRICHTUNG	ASTM A479 316/316L
8	STELO STEM TIGE SPINDEL	ASTM A479 304/304L ASTM A479 316/316L
9*	BUSSOLA STEM SEAL JOINT TIGE UNTERE SPINDELABDICHTUNG	P.T.F.E.
10*	PACCO A "V" CHEVRON RINGS JOINT A "V" 3 FACHE DACHMANSCHETTE	P.T.F.E. / GRAFITE P.T.F.E. / GRAPHITE P.T.F.E. / GRAPHITE P.T.F.E. / GRAPHIT

N.	DESCRIZIONE DESCRIPTION BESCHREIBUNG	MATERIALI MATERIALS MATERIAUX WERKSTOFFE
11	PREMIBUSSOLA PRESSING BUSH PRESSE RONDELLE STOPFBUCHSDRUCKRING	ASTM A479 304
12	MOLLE A TAZZA SPRING WASHERS RONDELLES BELLEVILLE TELLERFEDERN	C72/50Cr V4 X5CrNi17.7 or X12CrNi17.7 ZINCATO - GALVANIZED - ZINGUE - VERZINKT ON REQUEST
13	VITE DI FERMO E FERMO PIN AND STOP PIN PLOT ET PLOT D'ARRET ANSCHLAGBOLZEN	UNI 3740 8.8 UNI 3951 A2-70 ZINCATO - GALVANIZED - ZINGUE - VERZINKT ON REQUEST
14	DADO - CONTRODADO NUT - LOCK NUT ECROU - CONTRE-ECROU MUTTER - KONTERMUTTER	UNI 3740 - 6S ASTM A479 304 ZINCATO - GALVANIZED - ZINGUE - VERZINKT ON REQUEST
15	LEVA WRENCH LEVIER HANDHEBEL	AISI 1010 ASTM A479 304 ZINCATO - GALVANIZED - ZINGUE - VERZINKT ON REQUEST
16		
17	LATERALE END LATERAL GEGENGEHÄUSE	ASTM A 216 WCB ASTM A351 CF8M
18*	GUARNIZIONE GASKET JOINT DICHRING	P.T.F.E.
19	TIRANTE BOLT BOULON ZUGBOLZEN	ASTM A 193 B7 ZINCATO - GALVANIZED - ZINGUE - VERZINKT
20	DADO NUT ECROU MUTTEI	UNI 3740 - 6S ZINCATO - GALVANIZED - ZINGUE - VERZINKT

\* RICAMBI CONSIGLIATI - RECOMMENDED SPARE PARTS - PIECES DE RECHANGE CONSEILLEES - ERSATZTEIL EMPFEHLUNG

## DIMENSIONI - DIMENSION - DIMENSIONS - ABMESSUNGEN

DN	10	15	20	25	32	40	50	65	80	100	125	150	200	250	300
A						16	16	22	22	30	30	42	48		
B	VEDERE TYPE SEE FUTZ 4 VOIR PN 10 ÷ 16 SIEHE ANSI 150					10	10	14	14	18	18	28	32		
C						10	10	12	12	17	17	19	20		
E						38	51	64	76	101	118	152	203		
F						M6	M6	M8	M8	M10	M10	M12	M16		
ISO						F05	F05	F07	F07	F10	F10	F12	F14		
G						35	35	55	55	70	70	85	100		
H						109	119	143	152	172	185	253	295		
M						280	280	370	370	470	650	750	900		
P						55	65	82	90,5	99,5	113	144	183		
R						20	20	23	23	26	26	34	36		
S						200	230	290	310	350	400	550	600		
T						50	50	70	70	102	102	125	140		
~Kg						19	27	39	50	63	82	150	225		
~Kg												100	162		

- DATI E CARATTERISTICHE SOGGETTI A VARIAZIONI SENZA PREAVVISO
- SPECIFICATIONS SUBJECT TO MODIFICATION WITHOUT PRIOR NOTICE
- TOUS DROITS DE MODIFICATION RESERVES
- KONSTRUKTIONSÄNDERUNGEN VORBEHALTEN

ASTM A105 ASTM / A 182 F316- A479 S31600

ASTM A351 CF8M



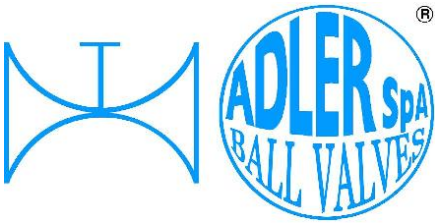

ISO 9001:2008 by L.R.  
 PED DIR. 97/23/EC by L.R.  
 ATEX DIR. 94/9/EC by B.V.  
 FIRE SAFE EXECUTION by L.R.  
 ISO 15848 by TÜV  
 ANTISTATIC DEVICE by L.R.  
 FIRE SAFE TESTED ISO 10497 by L.R.

TYPE  
**FV4**  
 PN 10 ÷ 40  
 ANSI 150

VALVOLA A SFERA "3 VIE" PASSAGGIO TOTALE 90°  
 BALL VALVES "3 WAY" FULL BORE 90°

ROBINETS A BOISSEAU SPHERIQUE "3 VOIES" PASSAGE INTEGRAL 90°  
 KUGELHÄHNE "3 WEGE VOLLER DURCHGANG 90°

• ESECUZIONI • EXECUTIONS • EXECUTIONS • AUSFÜHRUNGEN



EXECUTION 4 - 12

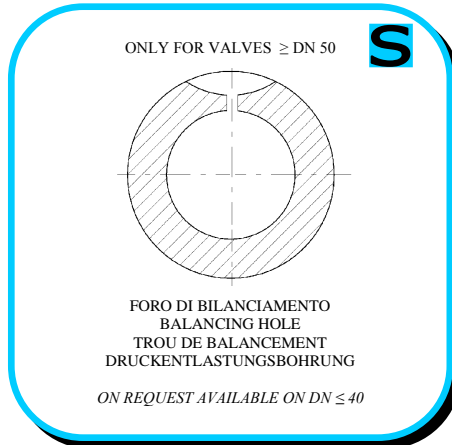

EXECUTION 6 - 16

**S** STANDARD

**O** OPTIONAL

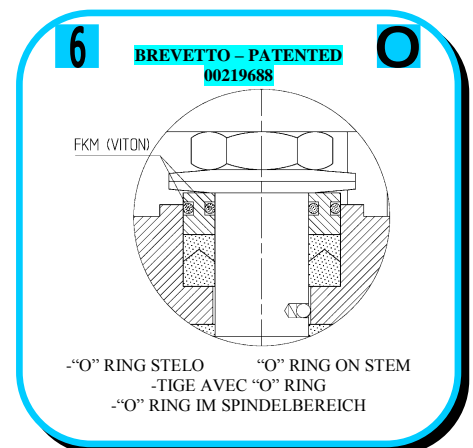
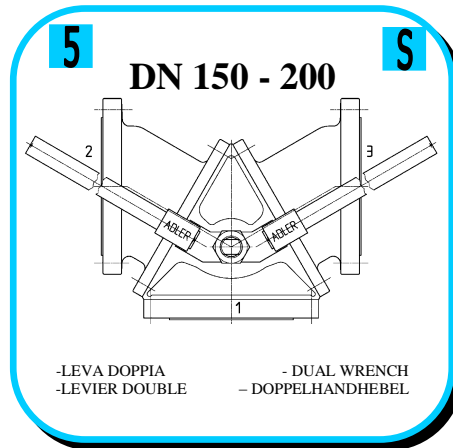
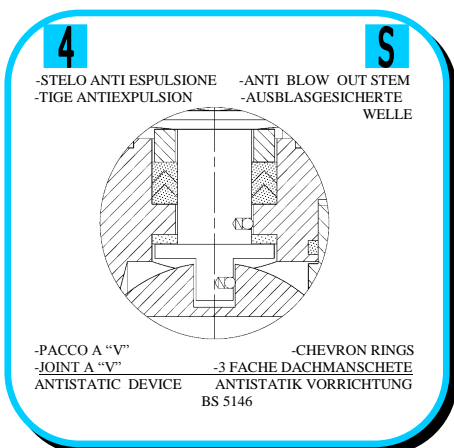
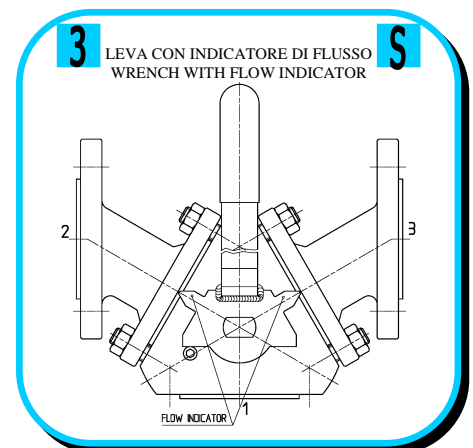
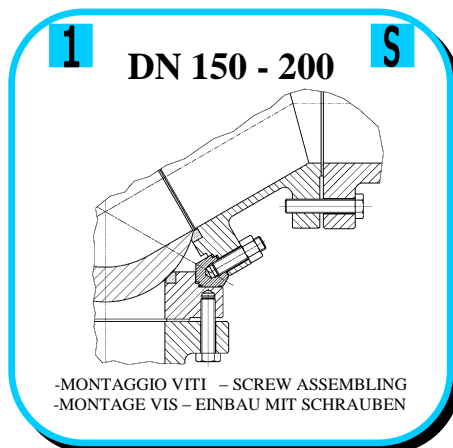
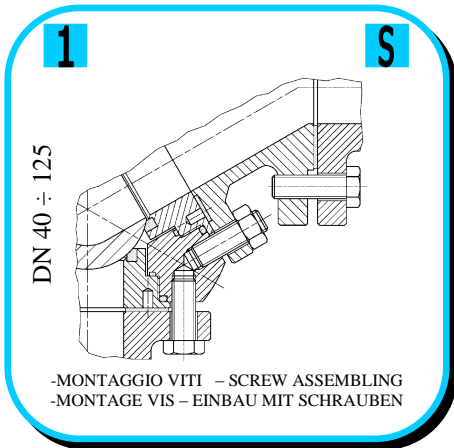

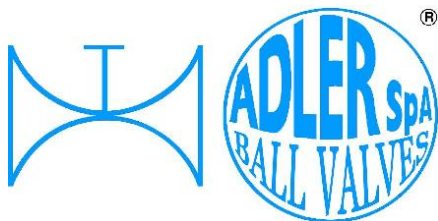

ISO 9001:2008 by L.R.  
 PED DIR. 97/23/EC by L.R.  
 ATEX DIR. 94/9/EC by B.V.  
 FIRE SAFE EXECUTION by L.R.  
 ISO 15848 by TÜV  
 ANTISTATIC DEVICE by L.R.  
 FIRE SAFE TESTED ISO 10497 by L.R.

TYPE  
**FV4**  
 PN 10 ÷ 40  
 ANSI 150

VALVOLA A SFERA "3 VIE" PASSAGGIO TOTALE 90°  
 BALL VALVES "3 WAY" FULL BORE 90°

ROBINETS A BOISSEAU SPHERIQUE "3 VOIES" PASSAGE INTEGRAL 90°  
 KUGELHÄHNE "3 WEGE VOLLER DURCHGANG 90°

• ESECUZIONI • EXECUTIONS • EXECUTIONS • AUSFÜHRUNGEN

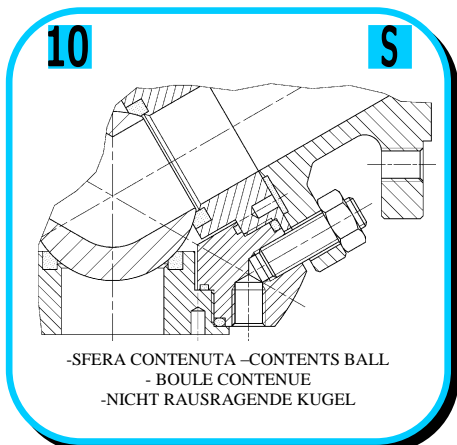
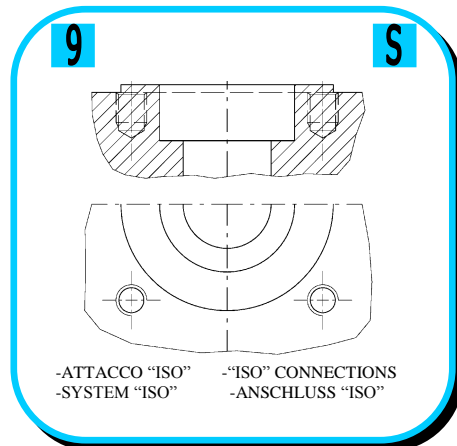
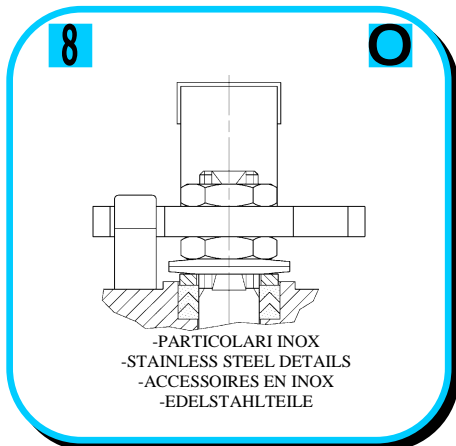
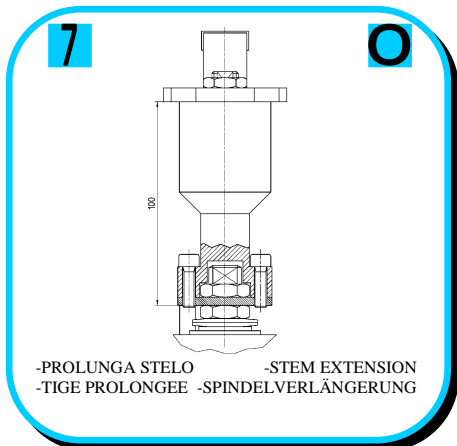

**ADLER**

UNA GAMMA COMPLETA  
 PRIVILEGIANDO LA QUALITA'

A COMPLETE RANGE PRIVILEGING  
 THE QUALITY

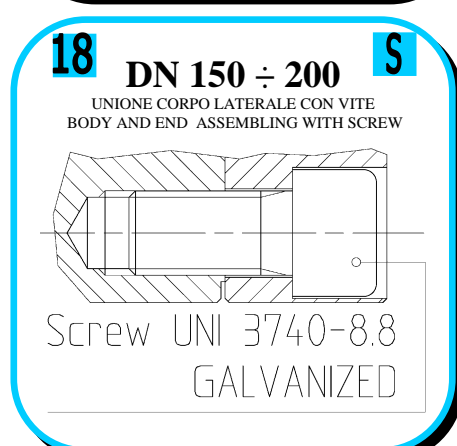
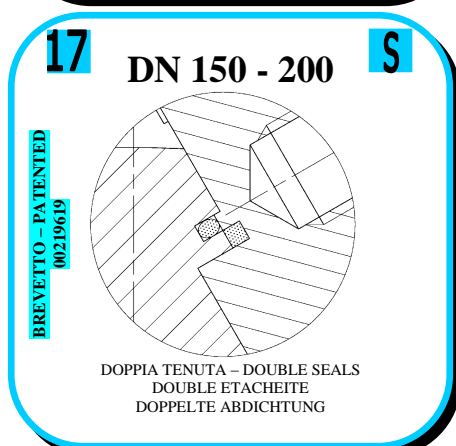
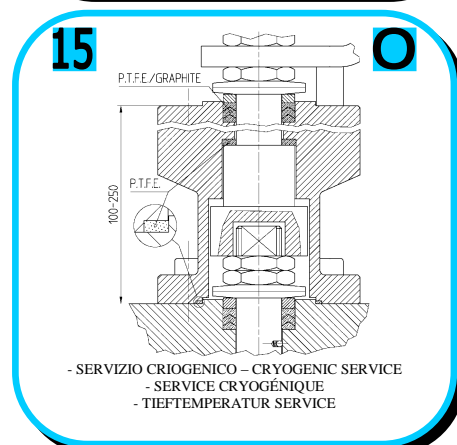
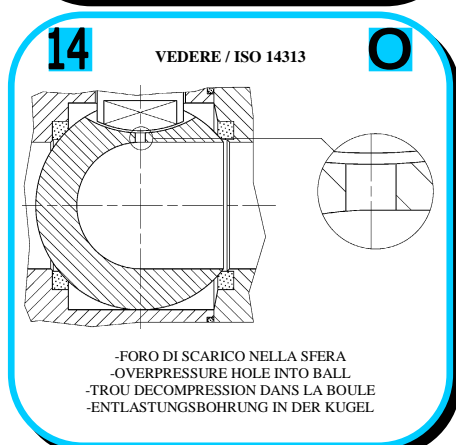
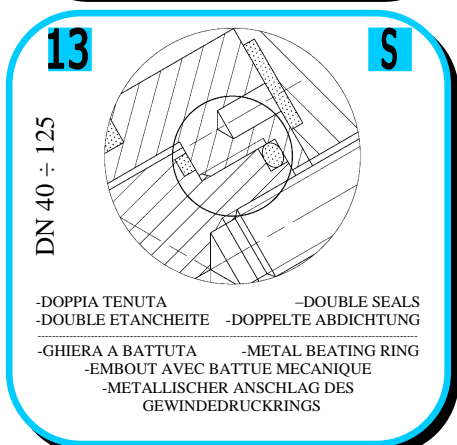

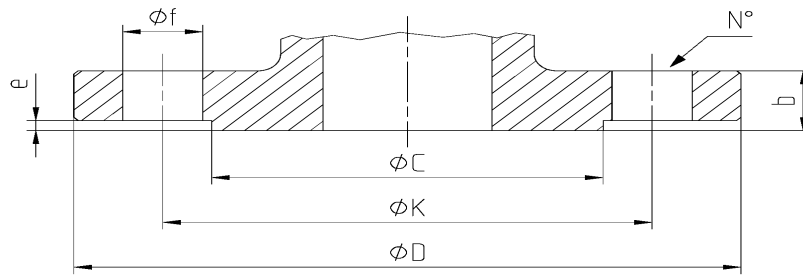

DN	Ref.	10	15	20	25	32	40	50	65	80	100	125	150	200	250	300
PN 10	D						150	165	185	200	220	250	285	340		
	C						88	102	122	138	158	188	212	268		
	K						110	125	145	160	180	210	240	295		
	N°						4	4	4*	8	8	8	8	8		
	f						18	18	18	18	18	18	22	22		
	b						18	18	18	20	20	22	22	24		
PN 16	e						3	3	3	3	3	3	3	3		
	D						150	165	185	200	220	250	285	340		
	C						88	102	122	138	158	188	212	268		
	K						110	125	145	160	180	210	240	295		
	N°						4	4	4*	8	8	8	8	12		
	F						18	18	18	18	18	18	22	22		
ANSI 150 RF	b						18	18	18	20	20	22	22	24		
	e						3	3	3	3	3	3	3	3		

**ANSI B16.5 (OPTIONAL)**

DN	Ref.	½"	¾"	1"	1 ¼"	1 ½"	2"	2 ½"	3"	4"	5"	6"	8"	10"	12"
ANSI 150 RF	D					127	152.4	177.8	190.5	228.6	254	279.4	342.9		
	C					92	104.7	127	157.3	185.7	215.9	269.8	269.8		
	K					98.6	120.7	139.7	152.4	190.5	215.9	241.3	298.5		
	N°					4	4	4	4	8	8	8	8		
	f					19.1	19.1	19.1	19.1	19.1	22.4	22.4	22.4		
	b					17.6	19.1	22.4	23.9	23.9	23.9	25.4	28.5		
ANSI 150 RF	e					1.6	1.6	1.6	1.6	1.6	1.6	1.6	1.6		

