

ISO 9001:2008 by L.R.  
PED DIR. 97/23/EC by L.R.  
ATEX DIR. 94/9/EC by B.V.  
FIRE SAFE EXECUTION by L.R.  
ISO 15848 by TÜV  
ANTISTATIC DEVICE by L.R.  
FIRE SAFE TESTED ISO 10497 by L.R.

TYPE  
**FF2**  
ANSI 150

NORME E DIRETTIVE APPLICATE DISPONIBILI AL SEGUENTE LINK:  
STANDARD AND DIRECTIVE APPLIED AVAILABLE AT FOLLOWING LINK:  
[http://www.adlerspa.com/pdf/NORME\\_ADLER.pdf](http://www.adlerspa.com/pdf/NORME_ADLER.pdf)

## VALVOLE A SFERA "ANSI B16.10" SPLIT BODY PASSAGGIO TOTALE

ISO nbr° LRC 0160281 QMS issued by L.R.Q.A. PED nbr° COV 0212112/01 issued by L.R.V.  
ATEX nbr° 40.2003.4392 issued by B.V. ISO 15848 nbr° I-148466/1-/2 issued by TÜV

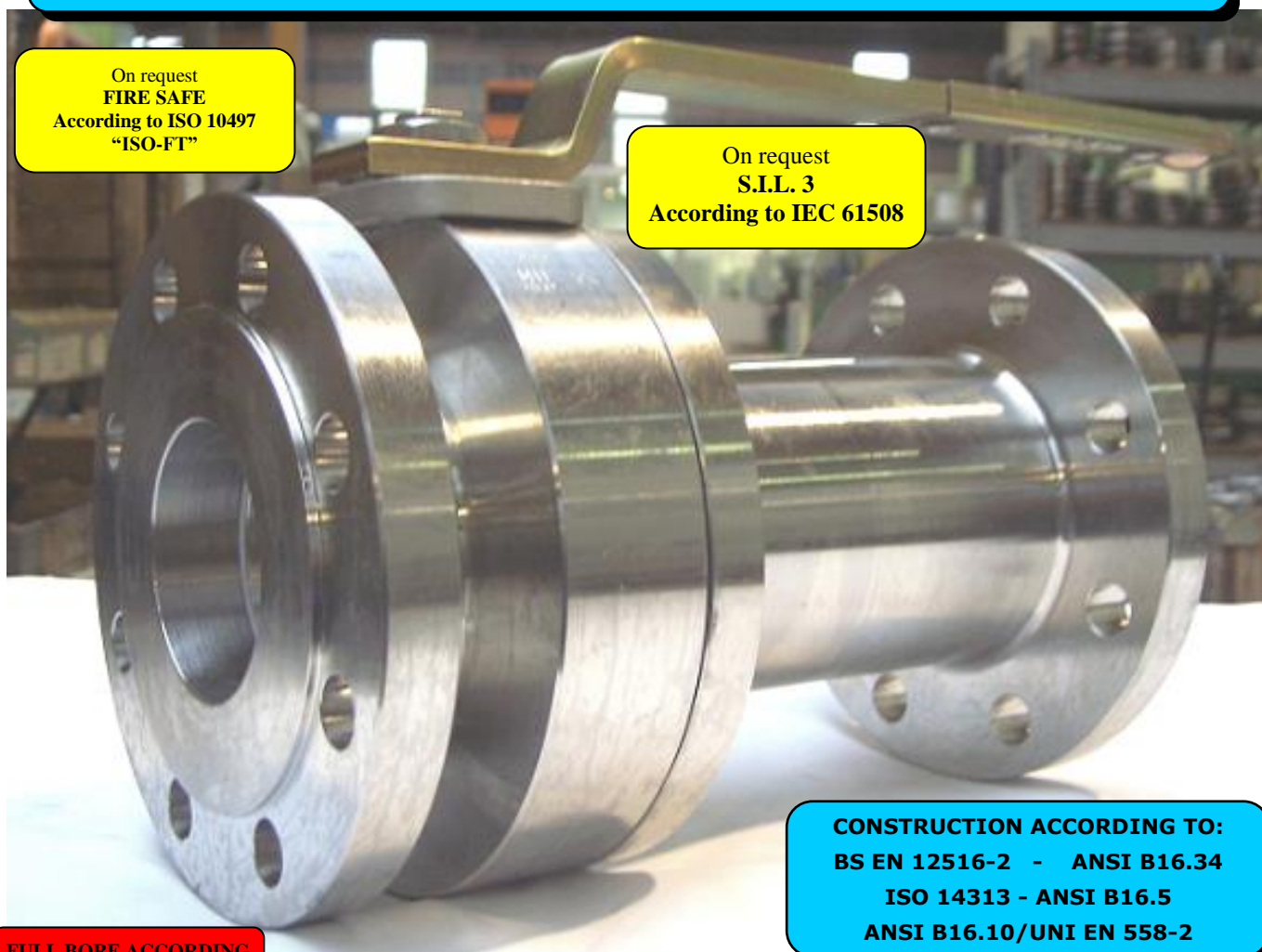

On request  
FIRE SAFE  
According to ISO 10497  
"ISO-FT"

On request  
S.I.L. 3  
According to IEC 61508

CONSTRUCTION ACCORDING TO:  
BS EN 12516-2 - ANSI B16.34  
ISO 14313 - ANSI B16.5  
ANSI B16.10/UNI EN 558-2

FULL BORE ACCORDING  
TO ISO 14313

**BALL VALVES**  
**"ANSI B16.10" FULL BORE SPLIT BODY**  
**ROBINETS A BOISSEAU SPHERIQUE**  
**"ANSI B16.10" PASSAGE INTEGRAL 2 PIECES**  
**FLANSCHKUGELHÄHNE IN "ANSI B16.10"**  
**VOLLER DURCHGANG ZWEIFTEILIGES GEHÄUSE**

WEB SITE: [WWW.ADLERSPA.COM](http://WWW.ADLERSPA.COM)

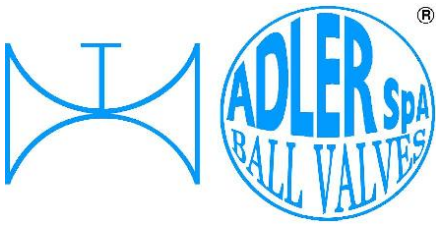

ISO 9001:2008 by L.R.  
 PED DIR. 97/23/EC by L.R.  
 ATEX DIR. 94/9/EC by B.V.  
 FIRE SAFE EXECUTION by L.R.  
 ISO 15848 by TÜV  
 ANTISTATIC DEVICE by L.R.  
 FIRE SAFE TESTED ISO 10497 by L.R.

TYPE  
**FF2**  
 ANSI 150

VALVOLA A SFERA "ANSI B 16.10" SPLIT BODY PASSAGGIO TOTALE  
 BALL VALVES "ANSI B 16.10" SPLIT BODY FULL BORE  
 ROBINETS A BOISSEAU SPHERIQUE "ANSI B 16.10" PASSAGE INTEGRAL 2 PIECES  
 FLANSCHKUGELHÄHNE IN "ANSI B 16.10" VOLLER DURCHGANG ZWEIFTEILIGES GEHÄUSE

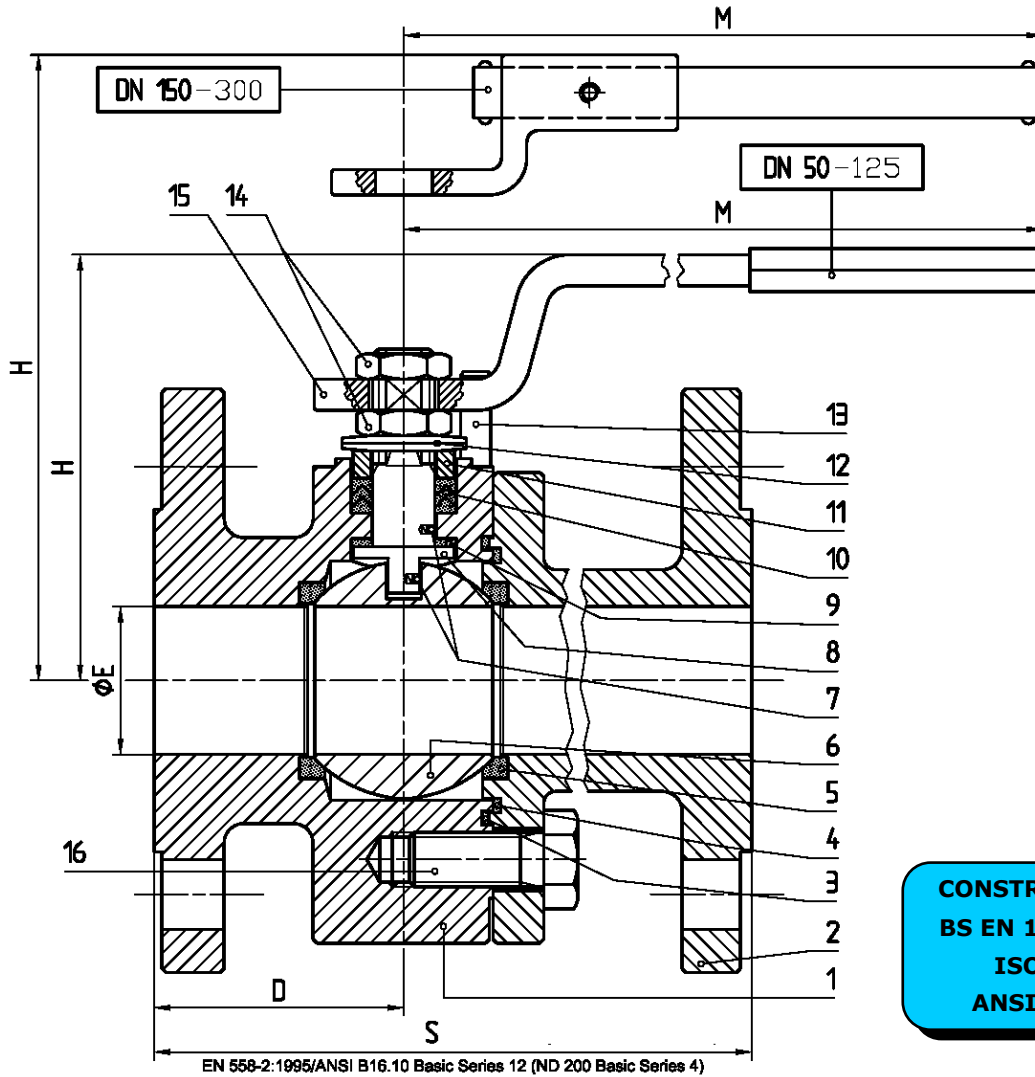

DN 200 ÷ 300  
 -CONSIGLIATO  
 RIDUTTORE MANUALE  
 -MANUAL GEAR BOX  
 SUGGESTED  
 -REDUCTEUR MANUEL  
 CONSEILLE  
 -EMPFEHLEN WIR EIN  
 HANDGETRIEBE

CONSTRUCTION ACCORDING TO:  
 BS EN 12516-2 - ANSI B16.34  
 ISO 14313 - ANSI B16.5  
 ANSI B16.10/UNI EN 558-2

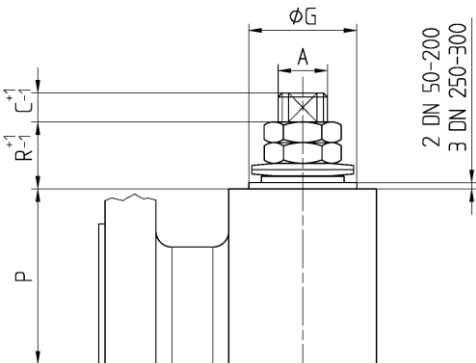

• ACCOPPIAMENTO VALVOLA  
 ATTUATORE  
 • CONNECTION VALVE  
 ACTUATOR  
 • ACCOUPLEMENT ROBINET-  
 ACTIONNEUR  
 • ZUSAMMENBAU KUGELHAHN  
 ANTRIEB  
**ISO-5211**

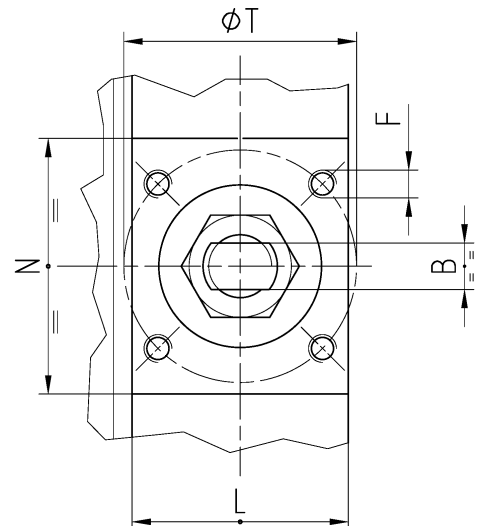

N.	DESCRIZIONE DESCRIPTION BESCHREIBUNG	MATERIALI MATERIALS MATERIAUX WERKSTOFFE
1	CORPO BODY CORPS KÖRPER	ASTM A105 ASTM A479 304/304L ASTM A479 316/316L ASTM A 351 CF8M
2	LATERALE END LATERAL GEGENGEHÄUSE	ASTM A105 ASTM A479 304/304L ASTM A479 316/316L ASTM A 351 CF8M
3*	O-RING	FKM - (VITON)
4*	ANELLO SEAL ANNEAU DICHTUNGSRING	P.T.F.E.
5*	SEDE SEAT SIEGE SITZRING	P.T.F.E. (BAM CERTIFIED) R.P.T.F.E. (OPTIONAL)
6	SFERA BALL BOULE KUGEL	ASTM A479 304/304L ASTM A351 CF8 ASTM A479 316/316L ASTM A351 CF8M
7	DISPOSITIVO ANTISTATICO ANTISTATIC DEVICE CONTACT ANTISTATIQUE ANTISTATIK VORRICHTUNG	ASTM A479 316/316L
8	STELO STEM TIGE SPINDEL	ASTM A479 304/304L ASTM A479 316/316L

N.	DESCRIZIONE DESCRIPTION BESCHREIBUNG	MATERIALI MATERIALS MATERIAUX WERKSTOFFE
9*	BUSSOLA STEM SEAL JOINT TIGE UNTERE SPINDELABDICHTUNG	P.T.F.E.
10*	PACCO A "V" CHEVRON RINGS JOINT A "V" 3 FACHE DACHMANSCHETTE	P.T.F.E. / GRAFITE P.T.F.E. / GRAPHITE P.T.F.E. / GRAPHITE P.T.F.E. / GRAPHIT
11	PREMIBUSSOLA PRESSING BUSH PRESSE RONDELLE STOPFBUCHSDRUCKRING	ASTM A479 304
12	MOLLE A TAZZA SPRING WASHERS RONDELLES BELLEVILLE TELLERFEDERN	C72/50Cr V4 X5CrNi17.7 or X12CrNi17.7 ZINCATO - GALVANIZED - ZINGUE - VERZINKT ON REQUEST
13	VITE DI FERMO E FERMO PIN AND STOP PIN PLOT ET PLOT D'ARRET ANSCHLAGBOLZEN	UNI 3740 8.8 UNI 3951 A2-70 ZINCATO - GALVANIZED - ZINGUE - VERZINKT ON REQUEST
14	DADO - CONTRODADO NUT - LOCK NUT ECROU - CONTRE-ECROU MUTTER - KONTERMUTTER	UNI 3740 - 6S ASTM A479 304 ZINCATO - GALVANIZED - ZINGUE - VERZINKT ON REQUEST
15	LEVA WRENCH LEVIER HANDHEBEL	AISI 1010 ASTM A479 304 ZINCATO - GALVANIZED - ZINGUE - VERZINKT ON REQUEST
16	VITE SCREW VIS SCHRAUBE	UNI 3740 8.8 UNI 3951 A2-70 ZINCATO - GALVANIZED - ZINGUE - VERZINKT ON REQUEST

\* RICAMBI CONSIGLIATI - RECOMMENDED SPARE PARTS - PIECES DE RECHANGE CONSEILLEES - ERSATZTEIL EMPFEHLUNG

## DIMENSIONI - DIMENSION - DIMENSIONS - ABMESSUNGEN

DN	15	20	25	32	40	50	65	80	100	125	150	200	250	300
A						16		22	30		42	48	56	56
B						10		14	18		28	32	36	36
C						10		17	17		19	20	20	20
D						76		75	77		117	155	196	237
E						51		76	101		152	203	254	305
F						M6		M8	M8		M12	M16	M20	M20
ISO						F05		F07	F07		F12	F14	F16	F16
G						35		55	55		85	100	130	130
H						120		152	174		256	294	343	381
L						53		62	64		129	176	185	153
M						280		370	470		750	900	1000	1000
N						64		65	70		109	123	153	153
P						65		86	99,5		144	183	220	258,5
R						20		23	26		34	36	44	44
S						203		241	305		394	457	533	610
T						50		70	70		125	140	165	165
~Kg						15		26,2	39		98	163	225	268
~Kg											72	124	182	217

- DATI E CARATTERISTICHE SOGGETTI A VARIAZIONI SENZA PREAVVISO
- SPECIFICATIONS SUBJECT TO MODIFICATION WITHOUT PRIOR NOTICE
- TOUS DROITS DE MODIFICATION RESERVES
- KONSTRUKTIONSÄNDERUNGEN VORBEHALTEN

ASTM A 105

ASTM A 351 CF8M



ADLER SpA - BALL VALVES  
20010 S. STEFANO TICINO (MI) ITALY V.le BORLETTI, 14 Tel. +39/02974842.11 FAX +39/0297271698  
E-mail: [adler@adlerspa.com](mailto:adler@adlerspa.com) <http://www.adlerspa.com>

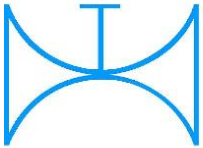

ISO 9001:2008 by L.R.  
 PED DIR. 97/23/EC by L.R.  
 ATEX DIR. 94/9/EC by B.V.  
 FIRE SAFE EXECUTION by L.R.  
 ISO 15848 by TÜV  
 ANTISTATIC DEVICE by L.R.  
 FIRE SAFE TESTED ISO 10497 by L.R.

TYPE  
**FF2**  
 ANSI 150

VALVOLA A SFERA "ANSI B16.10" PASSAGGIO TOTALE  
 BALL VALVES "ANSI B16.10" FULL BORE

ROBINETS A BOISSEAU SPHERIQUE "ANSI B16.10" PASSAGE INTEGRAL  
 FLANSCHKUGELHÄHNE IN "ANSI B16.10" VOLLER DURCHGANG

• ESECUZIONI • EXECUTIONS • EXECUTIONS • AUSFÜHRUNGEN

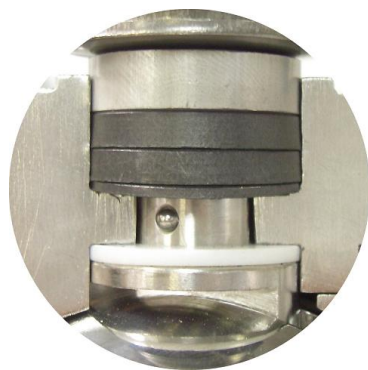

EXECUTION 4 - 12

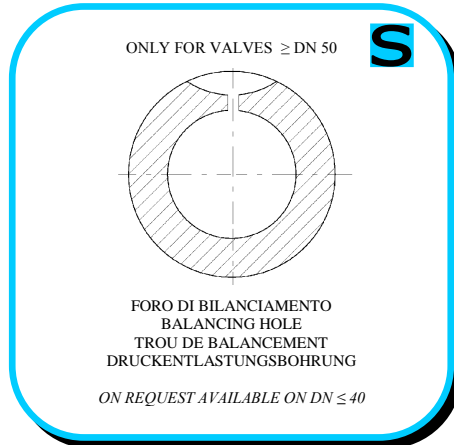

EXECUTION 6 - 16

**S** STANDARD

**O** OPTIONAL

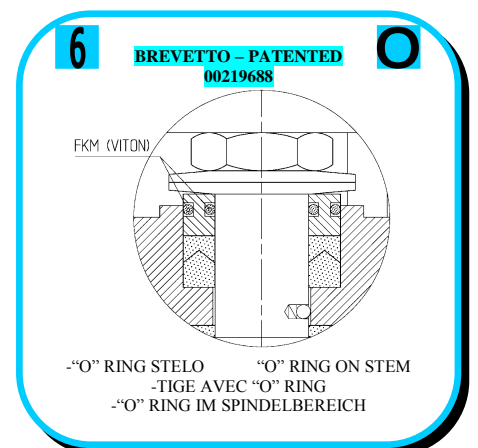
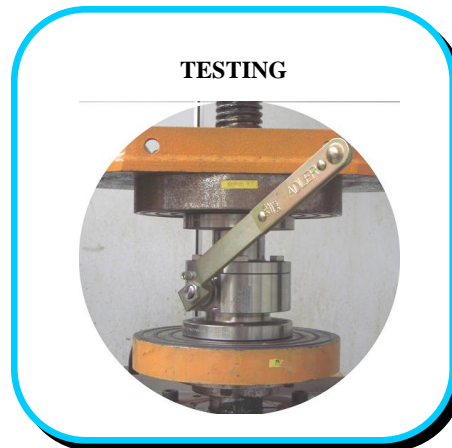
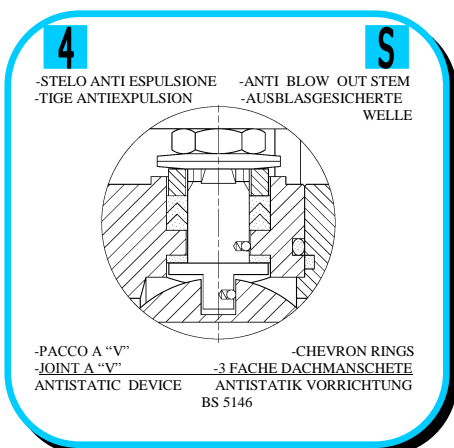
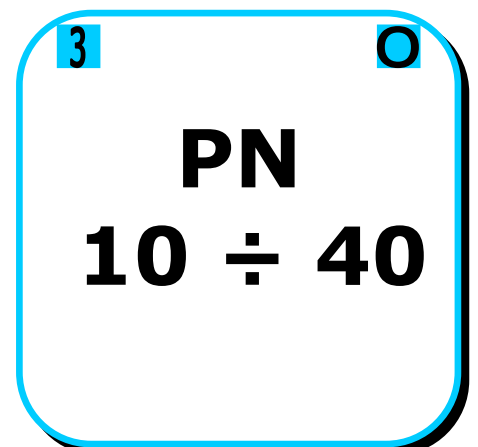

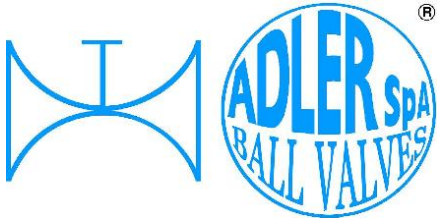

**ISO 9001:2008 by L.R.**  
**PED DIR. 97/23/EC by L.R.**  
**ATEX DIR. 94/9/EC by B.V.**  
**FIRE SAFE EXECUTION by L.R.**  
**ISO 15848 by TÜV**  
**ANTISTATIC DEVICE by L.R.**  
**FIRE SAFE TESTED ISO 10497 by L.R.**

**TYPE**  
**FF2**  
**ANSI 150**

**VALVOLA A SFERA "ANSI B16.10" PASSAGGIO TOTALE**  
**BALL VALVES "ANSI B16.10" FULL BORE**

**ROBINETS A BOISSEAU SPHERIQUE ANSI B16.10" PASSAGE INTEGRAL**  
**FLANSCHKUGELHÄHNE IN "ANSI B16.10" VOLLER DURCHGANG**

• ESECUZIONI • EXECUTIONS • EXECUTIONS • AUSFÜHRUNGEN

**7** **O**

-PROLUNGA STELO -STEM EXTENSION  
 -TIGE PROLONGEE -SPINDELVERLÄNGERUNG

**8** **O**

-PARTICOLARI INOX -STAINLESS STEEL DETAILS  
 -ACCESSOIRES EN INOX -EDELSTAHLTEILE

**9** **S**

-ATTACCO "ISO" "ISO" CONNECTIONS  
 -SYSTEM "ISO" -ANSCHLUSS "ISO"

**ISO 15848 CERTIFICATION**

**TUV**

**CERTIFICATE**

The certificate with No. 51484852 is the result of tests that took place performed on a

**ADLER S.p.A.**  
 Via S. Antonio, 200 20132 Sesto S. Giovanni (MI)

and conforms to the requirements of:

- EN ISO 15848 (Technical Drawing)
- EN ISO 15848-1 (Technical Drawing)
- EN ISO 15848-2 (Technical Drawing)

**COMPANY** ADLER S.p.A. Via S. Antonio, 200 - 20132 Sesto S. Giovanni (MI)

**TEST LOCATION** Laboratory QMCO, Monza (MI) and ADLER Production site

**TYPE OF TESTING** From 0° to 100° (Pressure 2005)

**TESTED VALUES** Ball valve, nominal diameter DN 50, nominal pressure Class 200 (25 bar), forged 90° body material ASTM A 479 316

**REQUIREMENTS** Compliance criteria of each testing system according to: TA LPT 66, July 2002, until Part 2, 2.4.1 and corrected VDS 2163 (date issue 1997-09-08) e.

- per ISO 15848: Evaluation Test (1000 cycles with three thermal cycles at 100°C/200°C and one fire test) (qualification 101)

- per ISO 15848: Evaluation Test (1000 cycles with three thermal cycles at 100°C/200°C and one fire test) (qualification 101)

**LEAK DETECTION METHOD** Helium Leak Detector (Helium Method): Mass Spectrometer type Babbari HL T 160

**PACKING MATERIAL** Chemura FFKM/Graphite ring

**PACKING SEALING CONFIGURATION** As per relevant drawing No. 14 F9 2 2798 1 to 4

**TEST RESULTS** Details of the test: Oncoo Test Report SP8002005

The described valve after testing system satisfies the TA LPT 66 requirements as well as EN ISO 15848

**QUALIFICATION** The testing system can be identified according to EN ISO 15848-1: Class B, 100% of thermal cycles with 300000 cycles (Adjustment) during 1800 cycles. Supplementary spring 60-10,000 cycles and one fire test. Confirmed the qualification.

**IMPORTANT:** This certificate must be referred to the ONCCO Test Report SP8002005 and the Adler Procedure: Q88 01.

LOCATION: MILANO 2650005

TUV INSPECTOR

**11** **O**

-TENUTA INTEGRALE -POCKETLESS SEATS  
 -TENUCE INTEGRALE -TOTRAUMARM  
 -P.T.F.E. / R.T.F.E.

**12** **O**

**FIRE SAFE**  
**ISO 10497 "ISO-FT"**  
**(BS 6755 / API 607)**

**13** **S**

**BREVETTO - PATENTED**  
 00219619

-DOPPIA TENUTA -DOUBLE SEALS  
 -DOUBLE ETANCHEITE -DOPPELTE ABDICHTUNG

-LATERALE A BATTUTA -METAL BEATING END  
 -LATERAL AVEC BATTUE MECANIQUE  
 -METALLISCHER ANSCHLAG DES GEGENGEHÄUSES

**14** **O**

**VEDERE / SEE ANSI B16.34**

FLUSSO  
 FLOW

-FORO DI SCARICO NELLA SFERA -OVERPRESSURE HOLE INTO BALL  
 -TROU DECOMPRESSION DANS LA BOULE  
 -ENTLASTUNGSBOHRUNG IN DER KUGEL  
**VALVOLA MONO DIREZIONALE**  
**MONO-DIRECTIONAL VALVE**

**15** **O**

P.T.F.E./GRAPHITE  
 100-250  
 P.T.F.E.

- SERVIZIO CRIOGENICO - CRYOGENIC SERVICE  
 - SERVICE CRYOGENIQUE  
 - TIEFTEMPORATUR SERVICE

**16** **O**

-FIRE SAFE ISO FT+ "O" RING STELO  
 -FIRE SAFE ISO FT+ "O" RING ON STEM  
 -SECURITE FEU ISO FT+ TIGE AVEC "O" RING  
 -FEUERSICHERE AUSFÜHRUNG ISO FT+ "O" RING IM SPINDELBEREICH

**17** **O**

-TENUTA INTEGRALE METALLICA -METALLIC POCKET LESS SEATS  
 -TENUCE INTEGRALE MATTALLIQUE -TOTRAUMARM METALLISCHES

**DIMENSION CHECK**

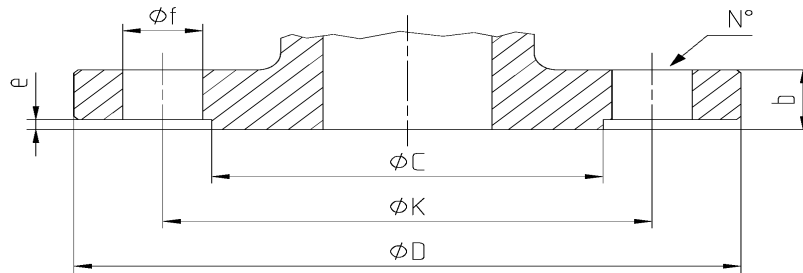

**ANSI B16.5**

DN	Ref.	½"	¾"	1"	1 ¼"	1 ½"	2"	2 ½"	3"	4"	5"	6"	8"	10"	12"	
ANSI 150 RF	D	88.9	98.6	108	117.4	127	152.4	177.8	190.5	228.6	254	279.4	342.9			
	C	35.1	43	50.8	63.5	92	104.7	127	157.3	185.7	215.9	269.8	269.8			
	K	6035	69.9	79.2	88.9	98.6	120.7	139.7	152.4	190.5	215.9	241.3	298.5			
	N°	4	4	4	4	4	4	4	4	8	8	8	8			
	f	15.8	15.8	15.8	15.8	19.1	19.1	19.1	19.1	19.1	22.4	22.4	22.4			
	b	11.2	12.7	14.3	15.8	17.6	19.1	22.4	23.9	23.9	23.9	23.9	25.4	28.5		
	e	1.6	1.6	1.6	1.6	1.6	1.6	1.6	1.6	1.6	1.6	1.6	1.6	1.6		

**EN 1092-1 (OPTIONAL)**

DN	Ref.	10	15	20	25	32	40	50	65	80	100	125	150	200	250	300	
PN 10/16	D		95	105	115	140	150	165	185	200	220	250	285	340			
	C		45	58	68	78	88	102	122	138	158	188	212	268			
	K		65	75	85	100	110	125	145	160	180	210	240	295			
	N°		4	4	4	4	4	4	4*	8	8	8	8	8			
	f		14	14	14	18	18	18	18	18	18	18	22	22			
	b		16	18	18	18	18	18	18	18	20	20	22	22	24		
	e		2	2	2	2	3	3	3	3	3	3	3	3	3		
PN 25/40	D		95	105	115	140	150	165	185	200	235	270	300	375			
	C		45	58	68	78	88	102	122	138	162	188	218	285			
	K		65	75	85	100	110	125	145	160	190	220	250	320			
	N°		4	4	4	4	4	4	8	8	8	8	8	12			
	f		14	14	14	18	18	18	18	18	22	26	26	30			
	b		16	18	18	18	18	20	22	24	24	26	28	34			
	e		2	2	2	2	3	3	3	3	3	3	3	3			

\* n°8 fori

